

USER MANUAL

QS BELT

The Inflatable lifebelt has an inflation valve either automatic or manual. To operate the manual valve you simply pull the toggle on the side of the lifebelt downwards with a jerk and the bladder will start to inflate immediately. The automatic lifebelt will operate and inflate once it has been immersed in water for three seconds. The automatic can be operated manually and both types can be inflated orally by the red oral tube. The oral tube is also used to deflate the lifebelt. After gas inflation the lifebelt must be rearmed.



Uninflated condition



Inflated condition



Safety control before use:

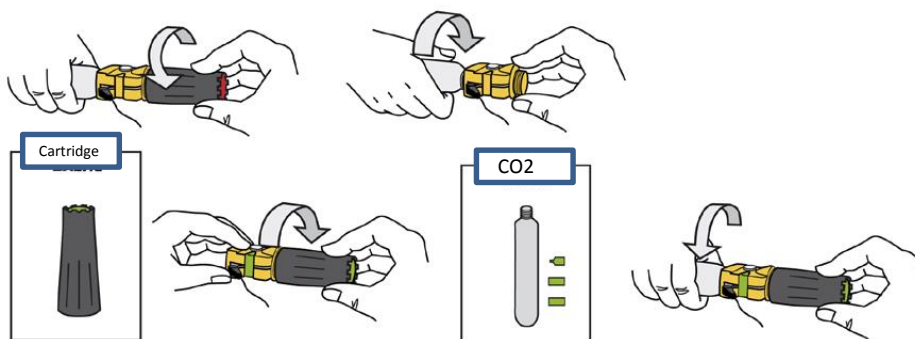

When automatic inflation need not do anything. Inflation will start automatically after about three seconds in the water. QS BELT has automatic inflation and you do not do anything. Inflation starts automatic for about three seconds in the water but the belt also has a manual inflator backup and a mouth valve you use if you want to blow up the belt by mouth. All products are deflated by mouth valve. The propellant in our cartridges are harmless carbon dioxide of food quality.. Note: After lifejacket been inflated it must be recharged. In purchasing manual is marking which rearming kit to use.

QS BELT includes::

- Outer holster
- Inflator mechanism,
- mouth valve
- fluorescent orange / yellow colored tube
- Whistle
- Drawstring
- waist strap with switch



DRAIN



The red mouth valve sits a black cap, lift the cap and invert so that the top is pressed against the green hole in the red tube.



Hold and press until all air is out and the orange / yellow tube is fully deflated.

Pre-wear check

Every time you wear your inflatable lifejacket you should check the following:

1. Check the CO2 cylinder

Unscrew the CO2 cylinder anti clockwise and make sure it is not pierced. Screw the unpierced CO2 cylinder back tightly by hand clockwise. A pierced CO2 cylinder is empty and must be replaced.

2. Check the safety indicators and cartridge/bobbin

Automatic version: Check both safety indicators. If either of the green indicators is missing and/or the CO2 cylinder is pierced the lifejacket must be rearmed. Carefully follow the instructions on the next page or the instructions enclosed with our rearming kits. Check that the cartridge/bobbin is in date. Manual version: Check the safety indicator. If it is missing, the O2 cylinder is empty and must be replaced. Carefully follow the instructions enclosed with our rearming kits.

3. Check pull knob Check that the manual inflation pull knob is accessible when donned.



REARMING

If your lifebelt has inflated automatically you have to replace the CO² cylinder and the automatic cartridge. Unscrew the CO² cylinders and cartridge. Check that there is a green security clip over the manual lever, attach a new one if this is missing. Mount a new cartridge, make sure it has a green safety pin on the bottom and the date on the cartridge is not expired. Mount a new CO² cylinder, check that it is not pierced before screwing it on. Use only hand force when assembling the parts. If your lifejacket is equipped with the Argus-valve, the two indicator windows will show green when the CO² cylinder and cartridge are correctly installed.

CONTROL OF CARTRIDGE

United Moulders cartridge

On the cartridge is printed the expiry date. E.G. **0418**, this would denote replace by April 2018.



RE-PACKING AND RECYCLING

QS BELT

Annual Self Inspection

Inflatable lifejackets demand regular inspections whether or not they have been used. Failure to carry out inspections may cause your lifebelt to malfunction. For further information please visit our web-site www.qsaverescue.com.



After checking that the new CO2 cylinder and cartridge replaced fold the holster with the yellow tube side facing inwards and the orange side is outward so that the release mechanism is visible.



The holster is folded over the orange hose, fasten all Velcro together.



Make sure that the red string hangs freely outside the black holster so you can pull it in case of manual emergency. Check to make sure the CO2 cylinder is new and non-perforated, and that cartridges date is not expired.

MORE INFORMATION and movies can be found on
www.qsaverescue.com

